

Joseph E. Walther Hall

**Where Indiana University School of Medicine Scientists
Will Invent Tomorrow's Medicine**



Joseph E. Walther Hall is the largest of the IU School of Medicine's newer research buildings. Walther Hall connects existing research buildings to create a massive, integrated biomedical complex that encourages research collaboration among scientists and physicians focused on:

- Adult and pediatric cancers
- Immunological challenges
- Developmental therapeutics
- Neurological diseases
- Genetic disorders and gene therapy
- Blood-related cancer and diseases

What's in Walther Hall?

- More than 125 research laboratories
- Stark Neurosciences Research Institute
- Center for Immunobiology
- Center for Environmental Health
- Gene Vector Production Suite
- Cell Repository / DNA Serum Bank
- Biosafety Level 3 Research Lab Suite
- Auditorium and conference center

Finances and Facts

Cost: \$83.3 million

Gross square feet: 254,000

\$329 per square foot

BRTC (2003): \$324/SF

RII (2003): \$219/SF

HITS (2007): \$249/SF

(Cost per square foot figures are estimates)

Sources of funds:

- \$33 million - Legislative authorization
- \$25 million - Academic research facil. bonds
- \$10 million - Riley Children's Foundation
- \$ 9 million - Indiana Genomics Initiative
- \$ 3.7 million - National Institutes of Health
- \$ 2.6 million - IU School of Medicine

Source: Office of Public and Media Relations, IU School of Medicine

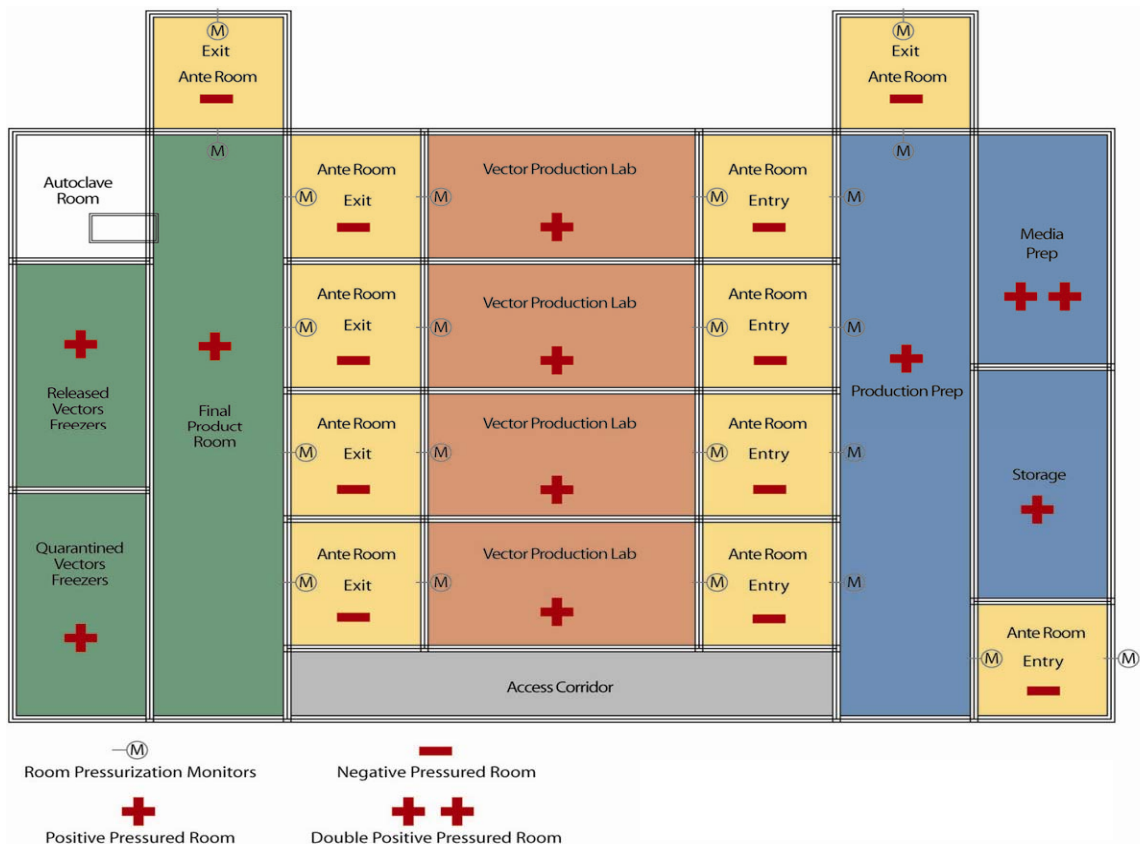

Indiana Vector Production Facility

- Provides fee-based services to academic, government and private industry researchers throughout the United States
- Services include:
 - Production of gene therapy vectors for research and for clinical trials (with appropriate approvals)
 - Certification testing services
- Administers the National Gene Vector Biorepository for the NIH

Importance of Walther Hall to IU School of Medicine and the State of Indiana

- Key to completion of current phase of IUSM expansion of its research enterprise
 - Enables recruitment of new faculty by providing necessary research facilities
 - Provides state-of-the-art laboratory space necessary for modern scientific research
 - Provides modern facilities for tissue collection and storage critical for future research
- Encourages collaboration among physicians and scientists with its location and connections to Research II, Cancer Research Institute, Indiana University Hospital, the Indiana University Melvin and Bren Simon Cancer Center, the Health Information and Translational Sciences Building and the Methodist Campus (via the People Mover)
- Supports the goals of the Indiana Clinical and Translational Sciences Institute